

Wisconsin Registered Land Surveyor S-1594

Rt. 3, Box 273  
Elkhorn, Wisconsin 53121  
Phone: (414) 723-4260 (office)  
(414) 723-4813 (residence)

### PLAT OF SURVEY

LEGAL DESCRIPTION: Lot 11 & Lot 13 of Hillview Park Subdivision, Located in the Southeast 1/4 of the Northwest 1/4 of Section 35, Town 4 North, Range 16 East, Town of La Grange, County of Walworth, State of Wisconsin.

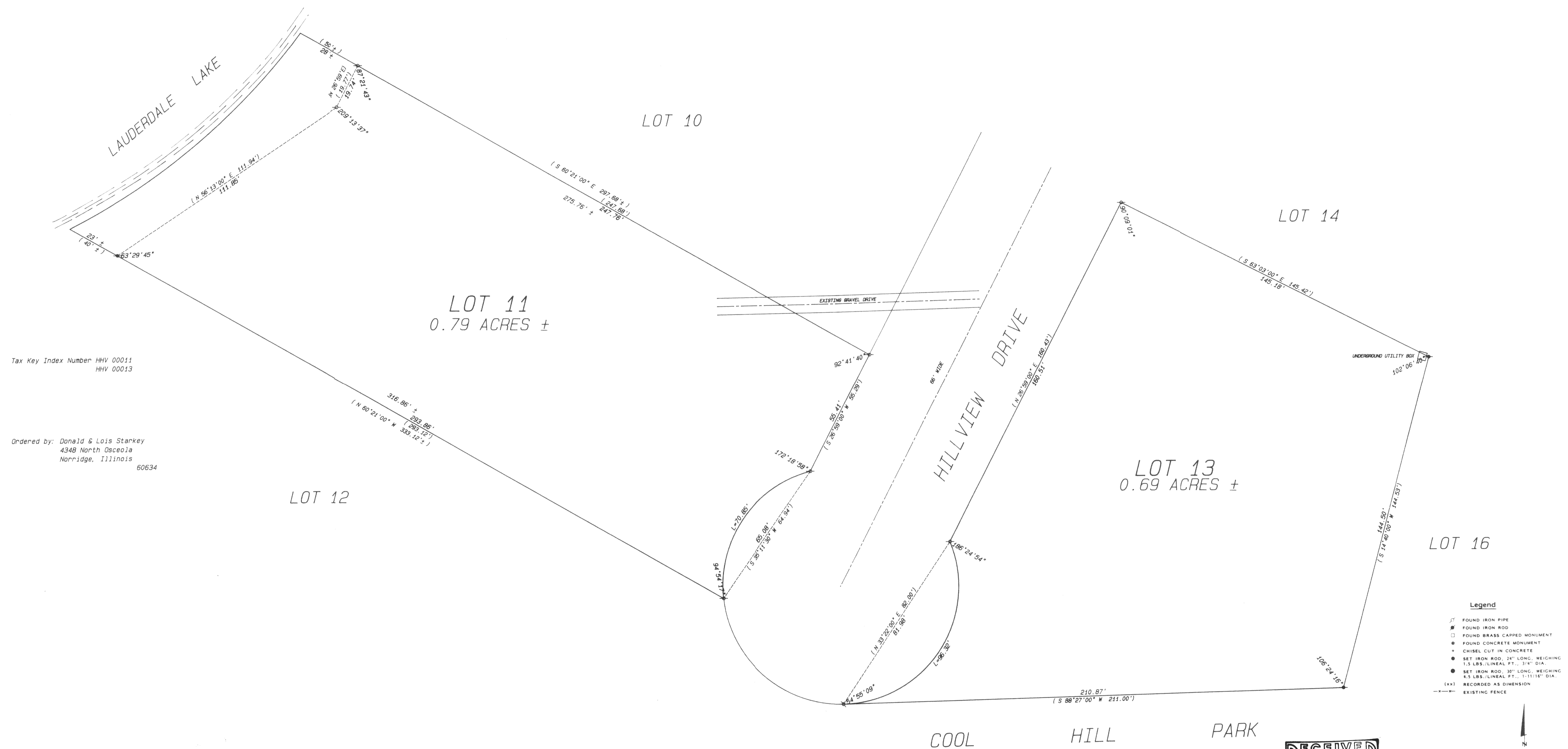

Tax Key Index Number HHV 00011  
HHV 00013

Ordered by: Donald & Lois Starkey  
4348 North Osceola  
Norridge, Illinois 60634

LOT 12

LOT 11  
0.79 ACRES ±









LOT 10

LOT 14

LOT 13  
0.69 ACRES ±

LOT 16

### Legend

-  FOUND IRON PIPE  
 FOUND IRON ROD  
 FOUND BRASS CAPPED MONUMENT  
 FOUND CONCRETE MONUMENT  
 CHISEL CUT IN CONCRETE  
 SET IRON ROD, 24" LONG, WEIGHING 1.5 LBS./LINEAL FT., 3/4" DIA.  
 SET IRON ROD, 30" LONG, WEIGHING 1.5 LBS./LINEAL FT., 1-11/16" DIA.  
 (xx) RECORDED AS DIMENSION  
 EXISTING FENCE



SCALE: 1" = 20 FEET

RECEIVED  
NOV 12 1990

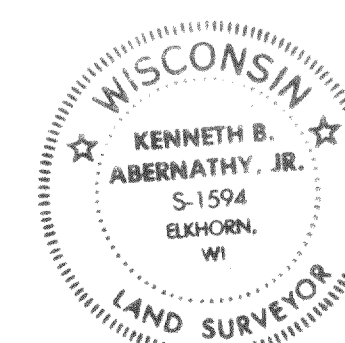

"I hereby certify that I have surveyed the above described property and that the above map is a true representation thereof and shows the size and location of the property, its extent, boundaries, the location of all visible structures and dimensions of all principal buildings thereon, boundary fences, apparent easements, roadways and visible encroachments, if any."

"This survey is made for the use of the present owners of the property, and also those who purchase, mortgage, or guarantee the title thereto within one year from date hereof."

Kenneth B. Anthony Jr.

KENNETH B. ABERNATHY, JR.  
WISCONSIN REGISTERED LAND SURVEYOR,  
S-1594

Date: 10/15/90 Job No. 90.1002

Tax Key # HHV 00011  
HHV 00013